

12TH FLOOR PLAN  
SCALE: 1:100

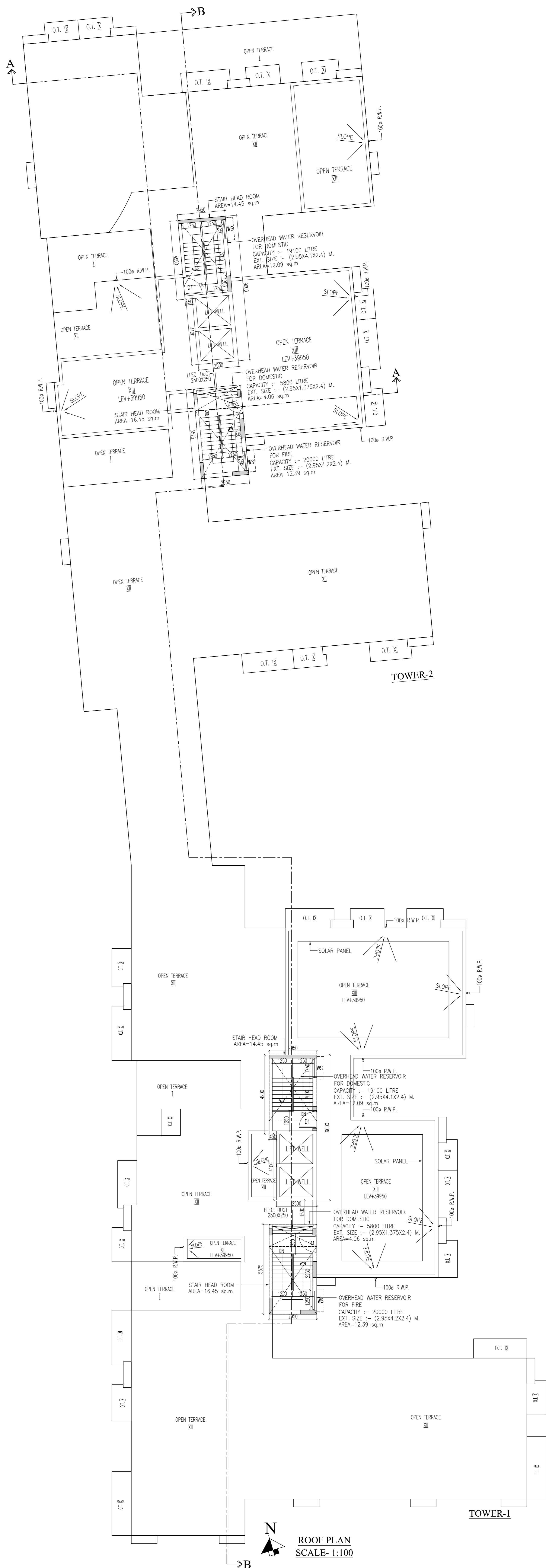

ROOF PLAN  
SCALE: 1:100

SCHEDULE OF DOORS & WINDOWS									
TYPE	SILL	LINTEL	SIZE	TYPE	SILL	LINTEL	SIZE		
D1	-	2100	1100x2100	W1	450	2100	1100x1650		
D2	-	2100	1100x2100	W2	900	2100	1300x1200		
D3	-	2100	1100x2100	W3	450	2100	1300x1650		
D4	-	2100	1100x2100	W4	450	2100	1800x1650		
D5	-	2100	1100x2100	W5	1050	2100	1100x1650		
D6	-	2100	1100x2100	W6	900	2100	1200x1200		
D7	-	2100	1100x2100	W7	900	2100	600x900		
D8	-	2100	1100x2100	W8	900	2100	600x900		
D9	-	2100	1100x2100	W9	1200	2100	600x900		
D10	-	2100	1100x2100	W10	450	2100	1100x1650		

**GENERAL NOTES**

- ALL DIMENSIONS ARE IN MM.
- ALL EXTERNAL WALLS 200 THK. & INTERNAL WALLS 125 THK. UNLESS OTHERWISE MENTIONED.
- ALL MASONRY WORKS ARE BOUNDED BY CEMENT MORTAR (1:6) & (1:4).
- EXTERNAL PLASTER IS 25 THK. & INTERNAL PLASTER IS 12MM THK. WITH 1:4 MORTAR.
- SALL CONC. GRADE IS M20 (1:1.5:3).
- SALL WARDROBES ARE 500 MM. WIDE.

**DISCLAIMER**

THE DIMENSIONS WHICH ARE SHOWN IN THE SANCTION PLAN (OR SALE DRAWING) APPROVED BY THE AUTHORITIES ARE BARE ARCHITECTURAL DIMENSIONS. PHYSICAL DIMENSION POST FINISHING WILL REDUCE DUE TO FINISHES SUCH AS PLASTER, POP, FLOORING ETC., RESULTING SOME REDUCTION IN CARPET AREA.

UNDERSIGNED HAS INSPECTED THE SITE AND CARRIED OUT SOIL INVESTIGATION THEREIN. IT IS CERTIFIED THAT THE EXISTING SOIL OF THE SITE IS ABLE TO CARRY THE LOAD COMING FROM THE PROPOSED CONSTRUCTION AND THE FOUNDATION SYSTEM PROPOSED HEREIN IS SAFE & STABLE IN ALL RESPECT FROM GEO-TECHNICAL POINT OF VIEW.

**NAME OF GEOTECH ENGINEER**  
JISHNU PAI  
B.TECH (CIVIL), M.E.(GEO-TECH)  
EMPANELLED NO. - G.T/32  
ADDRESS:  
UP GEO CONSULTANTS  
66, ANDUL ROAD, P.S-SANKARIL  
HOWRAH-700109

- ENGAGED ARCHITECT AND E.S.E DURING CONSTRUCTION.
- FOLLOWED THE INSTRUCTIONS OF ARCHITECT AND E.S.E DURING CONSTRUCTION OF THE BUILDING.
- K.M.C AUTHORITY WILL NOT BE RESPONSIBLE FOR STRUCTURE STABILITY BUILDING AND ADJOINING STRUCTURE.
- IF ANY SUBMITTED DOCUMENT IS FOUND TO BE FAKE THE K.M.C AUTHORITY MAY REVOKE THE SANCTION PLAN.
- THE CONSTRUCTION OF WATER RESERVOIR AND SEPTIC TANK EXECUTED UNDER THE GUIDANCE OF ARCHITECT & E.S.E.

**NAME OF OWNER**  
ANAND NBDITA  
CONSULTANT ATTORNEY OF  
THE INDA INDUSTRIAL MISSION PVT. LTD.

**CERTIFICATE OF ARCHITECT**

THE L.B.A. HAS CERTIFIED ON THE PLAN ITSELF WITH FULL RESPONSIBILITY THAT THE BUILDING PLAN HAS BEEN DRAWN UP AS PER PROVISION OF K.M.C. BLDG. RULES 2009, AS AMENDED FROM TIME TO TIME AND THAT THE SITE CONDITION INCLUDING THE WIDTH OF THE ABUTTING ROAD CONFORM WITH THE PLAN AND IT IS A BUILDABLE SITE AND NOT A TANK OR A FILLED UP TANK.

**NAME OF ARCHITECT**  
RAJ KUMAR AGARWAL  
COUNCIL REGISTRATION NO. CA/94/17940  
ADDRESS:  
RAJ AGRAWAL & ASSOCIATES  
88, ROYD STREET (2ND FLOOR), KOLKATA-16.

**CERTIFICATE OF STRUCTURAL ENGINEER**

CERTIFIED THAT, THE STRUCTURAL DRAWING & DESIGN OF BOTH FOUNDATION & SUPER STRUCTURE OF THE BUILDING/ BUILDINGS HAS BEEN MADE CONSIDERING THE SOIL TEST REPORT, AS PER THE RULES AND REGULATIONS MADE UNDER THE ACT AND ALSO CONSIDERING ALL POSSIBLE LOADS, SEISMIC LOAD AND THE MOMENTS GENERATED BY THE PROPOSED STRUCTURE AS PER THE BUREAU OF INDIAN STANDARD AND NATIONAL BUILDING CODE OF INDIA AND CERTIFIED THAT IT IS SAFE & STABLE IN ALL RESPECT AND THESE PROVISIONS SHALL BE ADHERED TO DURING THE CONSTRUCTION.

**NAME OF STRUCTURAL ENGINEER**  
SANJIV J. PAREKH  
ENROLLMENT NO. :-E.S.E. I (104)  
ADDRESS:  
34 RAMMOHAN DUTTA ROAD,  
KOLKATA-20.

**NAME OF STRUCTURAL REVIEWER**  
SANIB GUHA  
E.S.R. (08/16),  
ADDRESS:  
34 RAMMOHAN DUTTA ROAD,  
KOLKATA-20.

**TITLE**

GROUND FLOOR PLAN, SITE PLAN, LOCATION PLAN, EXISTING PLAN, UGW DETAIL, STP DETAIL.

**PLAN CASE NO.2022010053**

**PROJECT**

PROPOSED G+XII (39.95 M. HT.) STORED RESIDENTIAL BUILDING AT PREMISES NO. NO-5A, SEALS GARDEN LANE, KOLKATA -02 WARD NO. - 01, BOROUGH - 1, UNDER SECTION 303A OF KMC ACT 1900, COMPLYING KMC BUILDING RULB 2009.

THE PLAN CASE IS APPROVED AS PER RECOMMENDATION AND APPROVAL OF MBC MEETING NO. 609 DT. 17.01.2023 VIDE ITEM NO. 300 OF 2022-23.

**BUILDING PERMIT NO.2023010050**

DATE: 05/08/2023  
VALID UP TO: 04/08/2028

JOURNAL OF SIGN OF A/E(C)		JOURNAL OF SIGN OF E/S(C)	
DATE	DESIGN	DATE	CHECKED
19.05.22	ARCH/25/2021	BYA	NORMAL
SCALE		A R C H I T E C T	
RAJ AGRAWAL & ASSOCIATES 88, ROYD STREET, CALCUTTA - 16			